

# FOR SALE

## RESIDENTIAL - CONDOMINIUM 657SQFT (61SQM) / CALL FOR PRICE!

+65 8685 6686



2 - Bedroom Premium

**TYPE B5(b)**  
01-02-01 (607 sqft)  
02-01 to 02-01 (657 sqft)

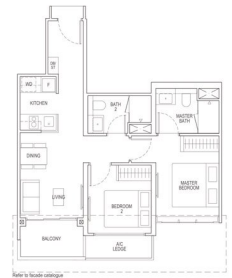

### RESIDENTIAL - CONDOMINIUM

IRWELL HILL, IRWELL BANK ROAD, ORCHARD,  
RIVER VALLEY, SINGAPORE 239588

- LISTING ID: SGLD41652964
- TENURE: LEASEHOLD 99
- TITLE: N/A
- SIZE BUILT-UP: 657SQFT (61SQM)
- SIZE LAND: 3.160AC (1.279HA)
- NO. OF FLOORS: 36
- FLOOR/LEVEL: N/A - N/A
- BED ROOMS: 2
- BATH ROOMS: 2
- MAIDS ROOMS: N/A
- PARKING SPACES: N/A
- LAYOUT TYPE: OTHER
- FACING: N/A
- VIEWING: OTHER
- SELLING PRICE: **CALL FOR PRICE!**
- COMPLETION YEAR: 2025
- CONDITION: ORIGINAL CONDITION
- FURNISHING: PARTIALLY FURNISHED
- LISTING DATE: SEP 29, 2021

### IRWELL HILL RESIDENCES

Condominium for Sale: Partially furnished, 2 bedroom, 2 bathroom. Completed in 2025, this unit is in original condition. Tenure: Leasehold 99 Located in Singapore's district D09 near Orchard, River Valley in the area Orchard (Central region).

#### INTERIOR FACILITIES

- Air-Conditioning
- Balcony
- Internet Connection

#### OTHER INTERIOR FEATURES

- Cooker Hob/Hood
- Dryer
- Fridge
- Intercom

#### EXTERIOR FACILITIES

- 24 Hours Security
- Covered Car Park
- Function Room
- Library / Reading Room

VISIT THIS PROPERTY AT: <https://www.rightproperty.com.sg/property/SGLD41652964>



### JEAN KOH - HUTTONS ASIA PTE LTD

3 Bishan Place  
#05-01 CPF Bishan Building (Attn: R023574E), D20, 579838, Singapore

+65 8685 6686  
WhatsApp Me

jean.koh@hotmail.com

L3008899K  
R023574E

<https://www.rightproperty.com.sg>



Scan QR Code

RIGHT  
PROPERTY